

## MORE STRENGTH. MORE STABILITY.

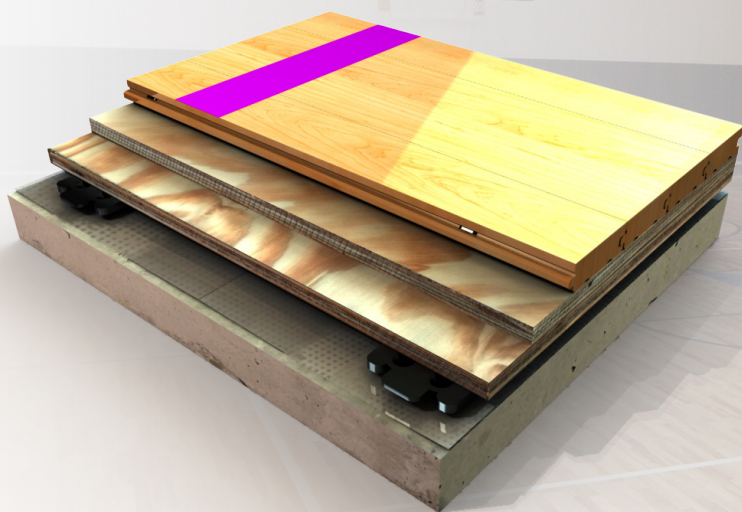

The sports flooring industry's first truly bio-mechanically designed and tested suspended maple flooring system, Bio-Cushion Classic has become one of the most popular resilient systems available. The Bio-Cushion system is bio-mechanically engineered for enhanced comfort and performance levels for athletes of all levels. Playing characteristics can be "tuned" depending on usage requirements to maximize resiliency and reduce the negative effects of the floor on the athlete.

- As a result of combining a thicker maple surface, dual layer subfloor, and resilient bio-pads, this floor can be perfectly fine tuned for aerobics, ballet, and martial arts, in addition to gymnasium flooring
- Excellent non-athletic load bearing capabilities with a continuous subfloor that adds strength and load stability throughout the floor



robbinsfloor.com | 1.800.543.1913

Robbins, Inc. | 4777 Eastern Avenue | Cincinnati, OH 45226

## Product Specifications

System Type	Floating Panel
Slab Depression	<p>2 1/8" (54mm) with 25/32" (20mm) maple and 7/16" (11mm) pad</p> <p>2 3/8" (60mm) with 33/32" (26mm) maple and 7/16" (11mm) pad</p> <p>2 1/2" (64mm) with 25/32" (20mm) maple and 3/4" (19mm) pad</p> <p>2 3/4" (70mm) with 33/32" (26mm) maple and 3/4" (19mm) pad</p> <p><i>Other options available</i></p>
Surface- MFMA Northern Hard Maple	Robbins Continuous Strip® XL (FJ) or Random Length (RL)
Subfloor Construction	2 layers of nominal 1/2" x 48" x 96" (12mm x 1219mm x 2438mm) exposure 1, rated subfloor sheathing
Resilience Layer	Many pad options available
Vapor Barrier	6 MIL Polyethylene
Optional Construction	Contact a Robbins Representative for Alternative Systems
LEED Contributions	<p>MR credit 4, 5, &amp; 7</p> <p>IEQ 4.1, 4.2, 4.3, 4.4</p> <p>FSC® Lumber Available</p> <p><i>*Credits are based on products selected and location of facility</i></p>
<p>The mark of responsible forestry</p>	
Warranty <b>Egis</b> FLOORLIFE®	1 year Industry Standard with optional Extended Warranty Program ( <i>Egis Floorlife</i> )

Wall View

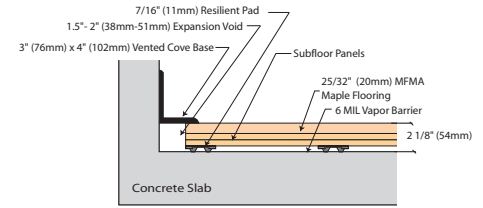

Threshold View

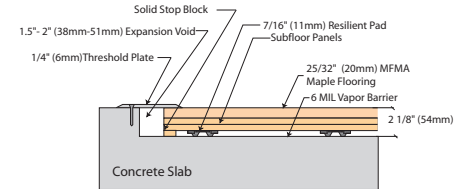

Equipment View

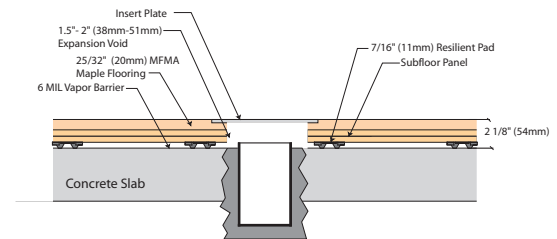

### Bio-Cushion Family Reference Facilities

Texas A&M University  
 Terwillegar Community Recreation Centre  
 California State University- East Bay  
 LA Fitness  
 Lourdes High School  
 Cambridge High School  
 Columbus Grove  
 Huffman High School  
 Durant High School  
 Harvest Ridge High School  
 Claremore High School  
 Iager High School

robbinsfloor.com | 1.800.543.1913